

Notice de pose du faisceau électrique pour
crochet d'attelage avec prise 13 voies

Version : 5 DOORS

Année : 09/2007 →

Réf : 173366

LAGUNA 3



0 H 45

Einbauanleitung elektrosatz Anhängervorrichtung mit Steckdosen 13-Polig
Fitting instructions electric wiringkit towbar with socket 13-pin
Montage-handleiding elektrokabelset voor trekhaak met contactdoos 13-polig

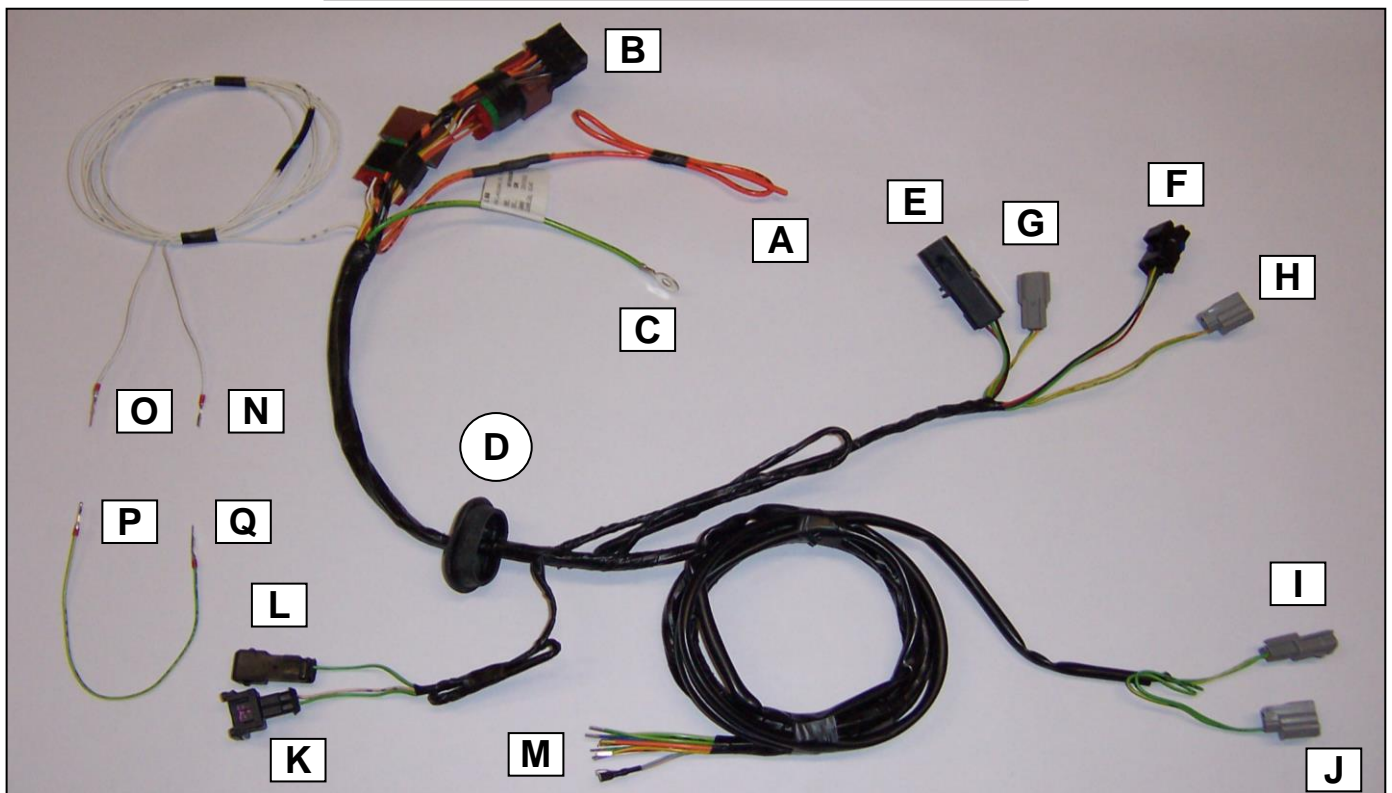
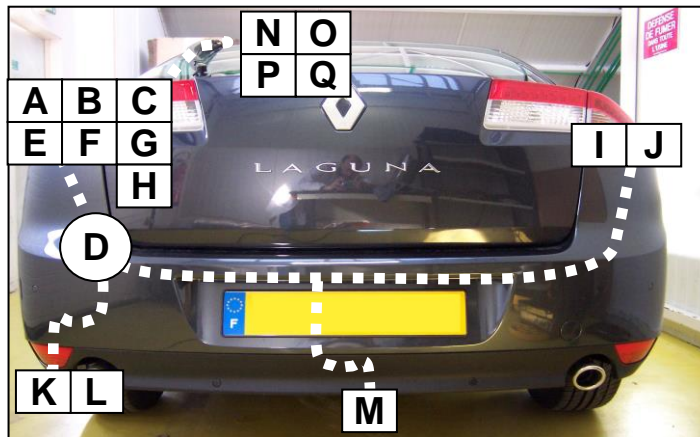

Liste des pièces / Teilliste / Part list / Onderdelenlijst :

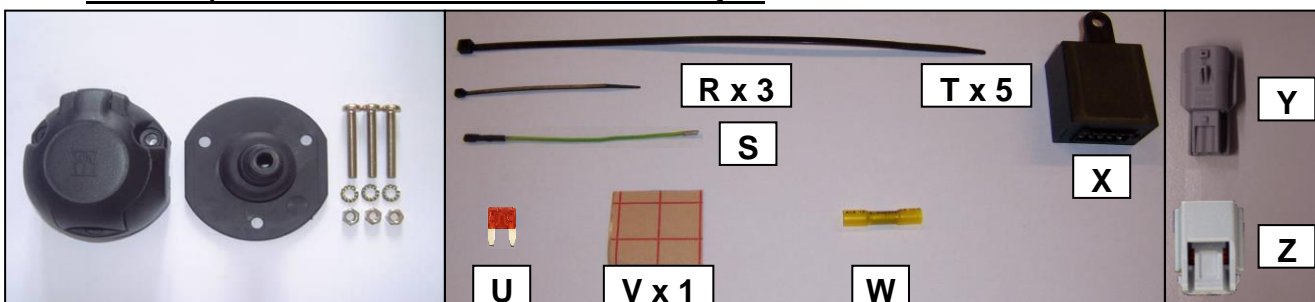

Cette notice ne peut être divulguée ou reproduite, partiellement ou en totalité, sans accord de la société.

1

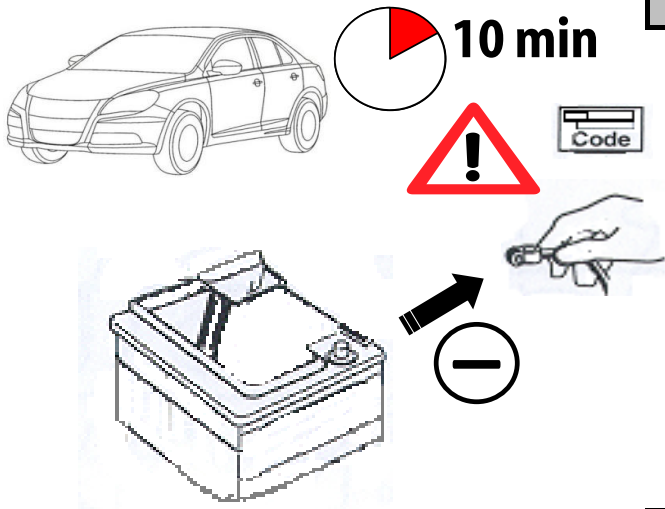

2



3



4



5



6

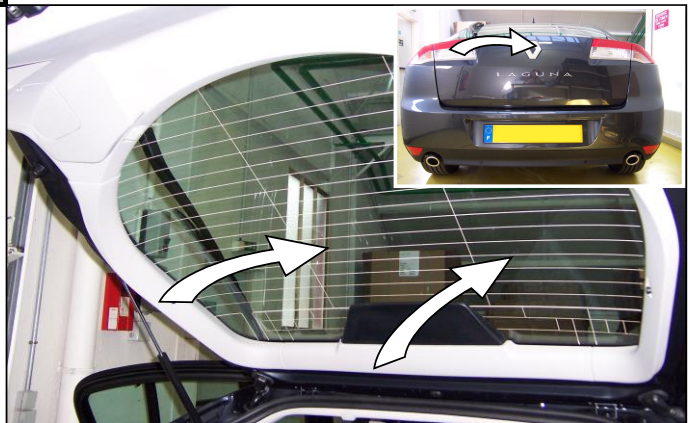

7

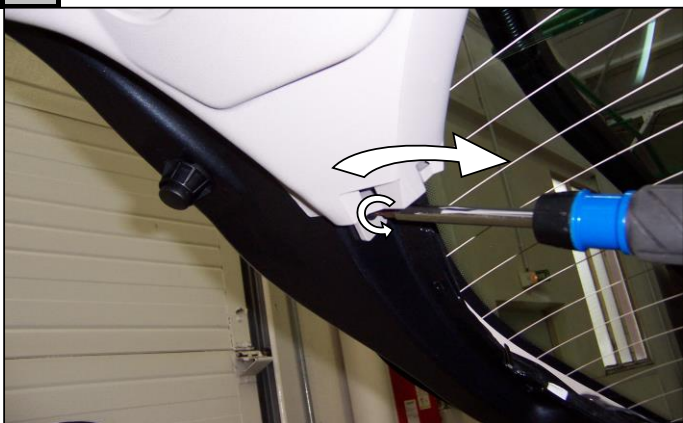

8

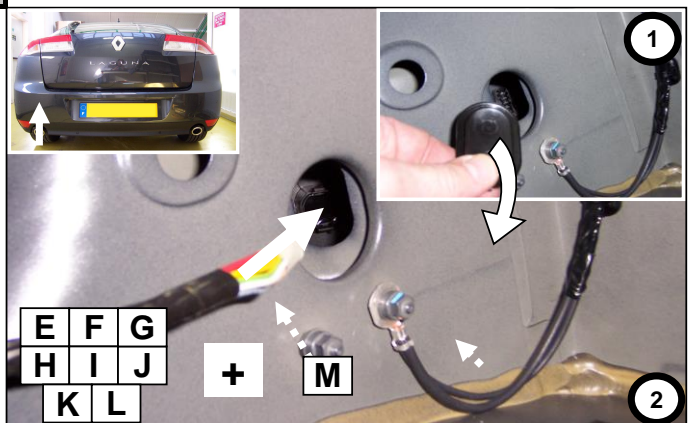

| | 1/L | 2/54g | 3/31 | 4/R | 5/58R | 6/54 | 7/58L | 8 | 9 | 13 | (C) | (D) |
|-----------|------------|--------------|-------------------|------------|--------------|-------------|--------------|----------|----------------|-------------------|------------|------------|
| | | | | | | | | | | | | |
| | 21+5 W | 21W | 1 mm ² | 21+5 W | 40 W | 63 W | 40 W | 42 W | 100 W | 2 mm ² | | |
| F | Jaune | Bleu | Vert/jaune | Vert | Marron | Rouge | Noir | Blanc | Orange | Vert/jaune | Gris | Beige |
| D | Gelb | Blau | Grün/gelb | Grün | Braun | Rot | Schwarz | Weiß | Orange | Grün/gelb | Grau | Beige |
| GB | Yellow | Blue | Green/yellow | Green | Brown | Red | Black | White | Orange | Green/yellow | Grey | Beige |
| NL | Geel | Blauw | Groen/geel | Groen | Bruin | Rood | Zwart | Wit | Oranje | Groen/geel | Grijs | Beige |
| P | Amarelo | Azul | Verde/amarelo | Verde | Castanho | Vermelho | Preto | Branco | Cor de laranja | Verde/amarelo | Cinzentos | Beige |
| I | Giallo | Blu | Verde/giallo | Verde | Marrone | Rosso | Nero | Bianco | Arancio | Verde/giallo | Grigio | Beige |
| E | Amarillo | Azul | Verde/amarillo | Verde | Marron | Rojo | Negro | Blanco | Anaranjado | Verde/amarillo | Gris | Beige |

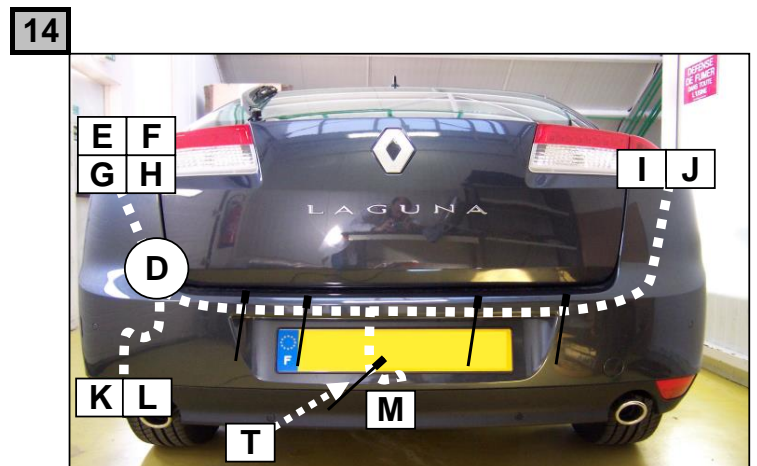
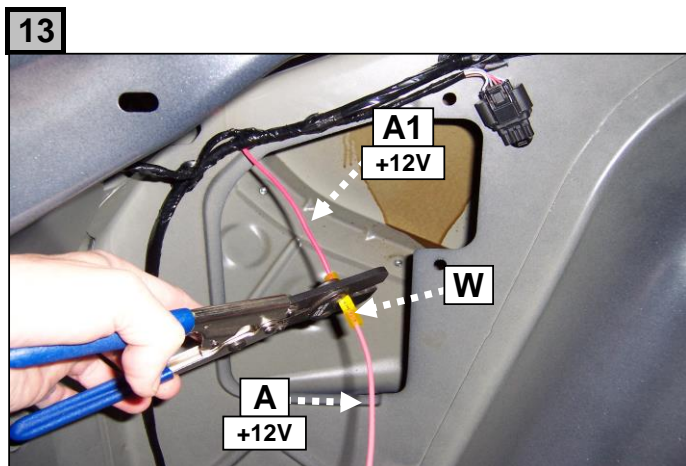
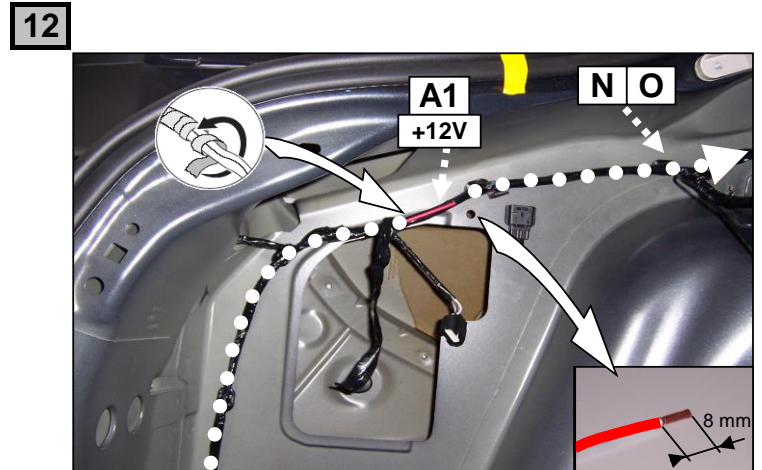
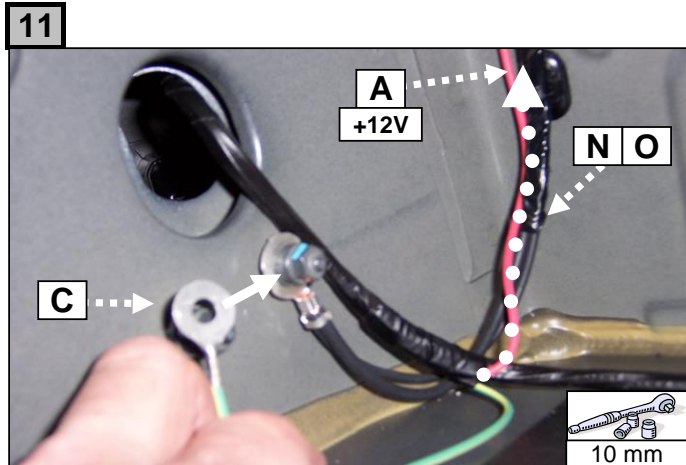
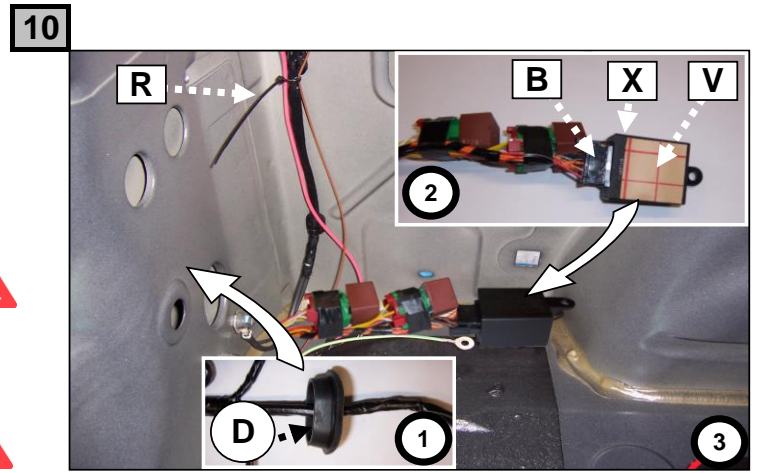
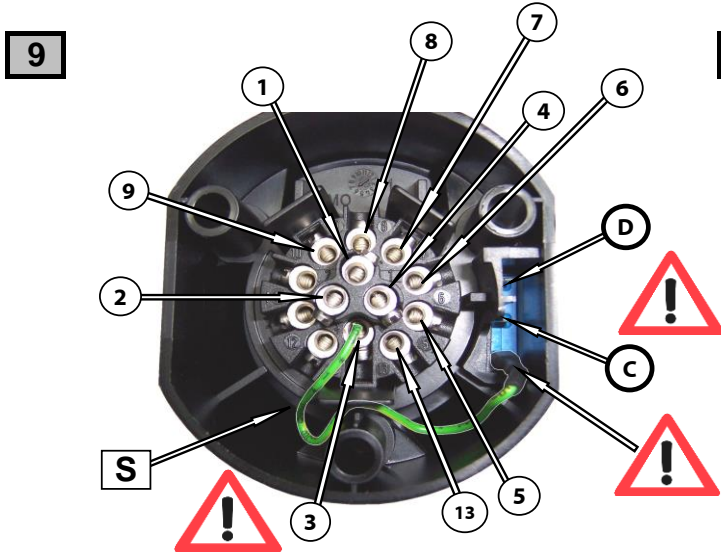

15

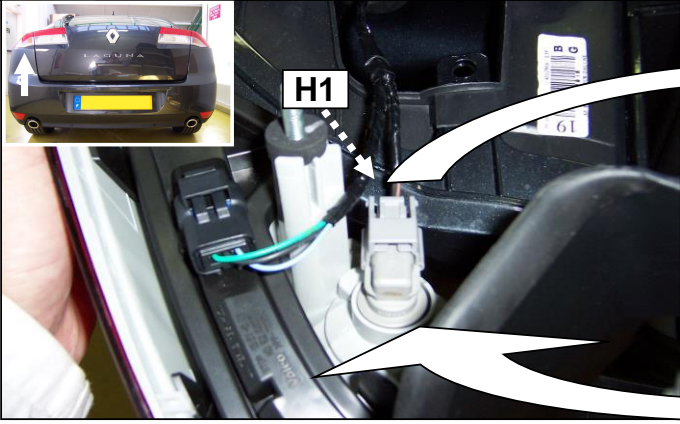

16

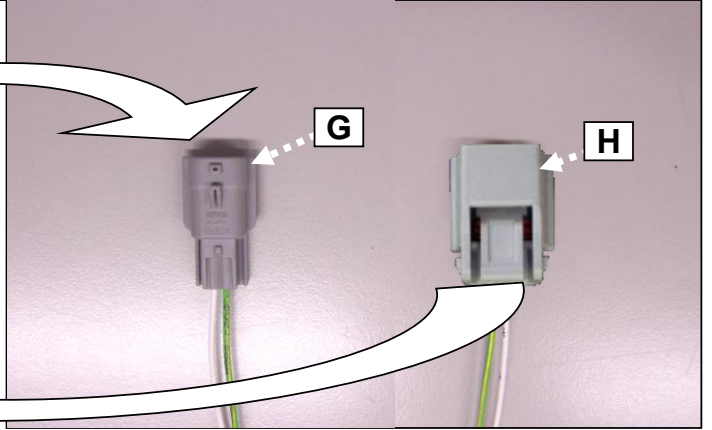

17

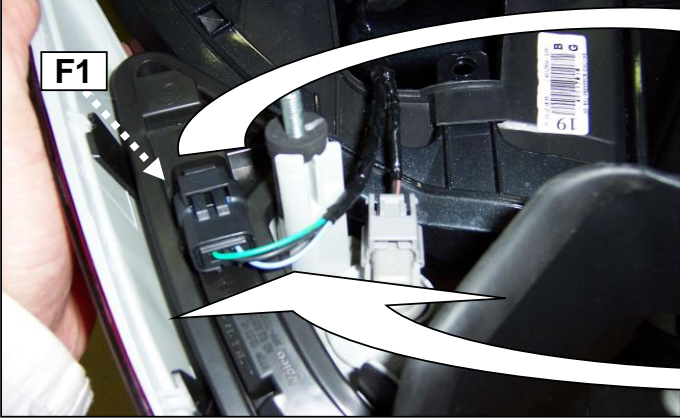

18

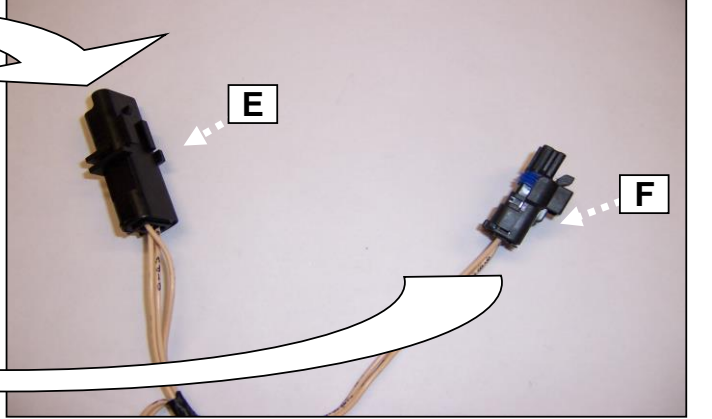

19

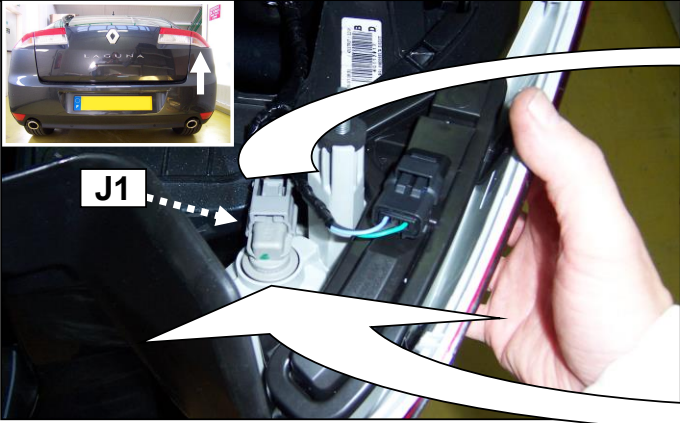

20

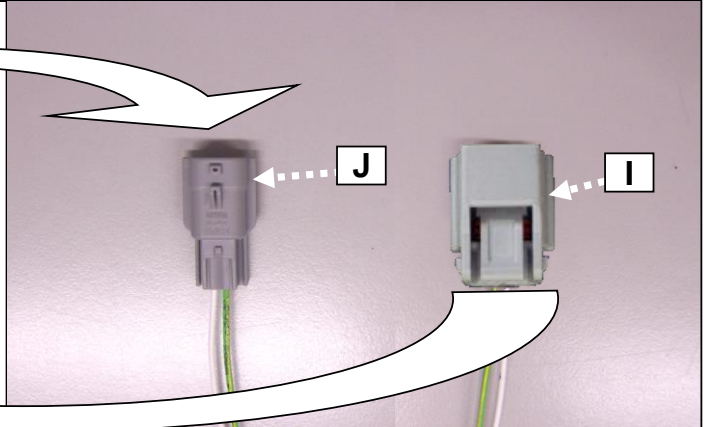

21



22

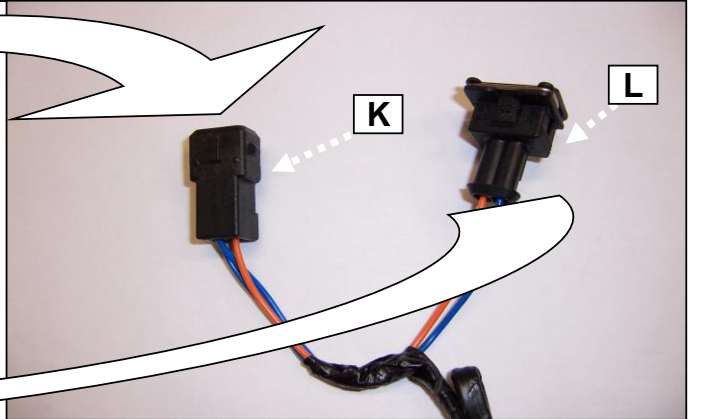

23

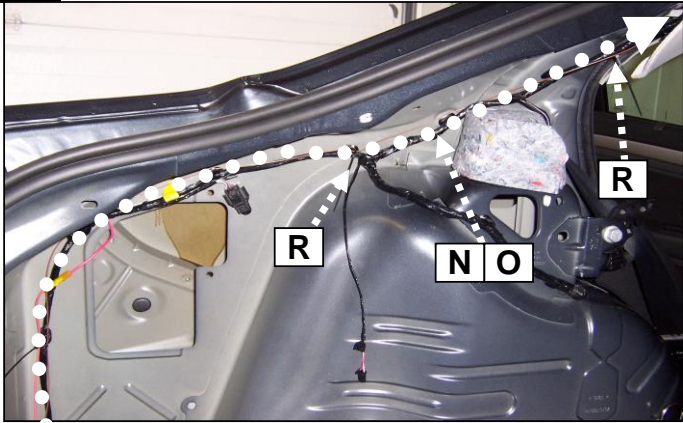

24



25



26

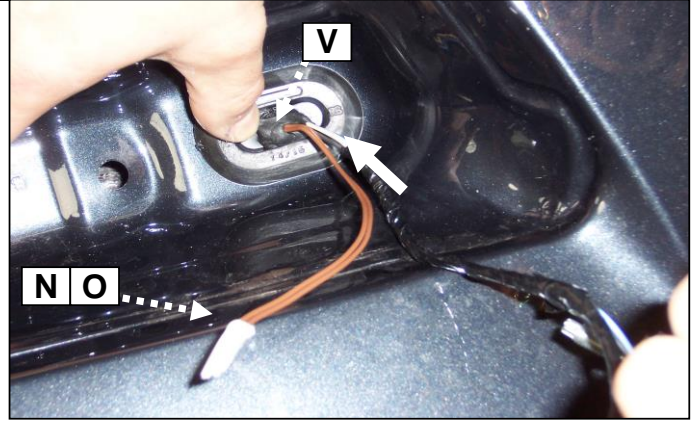

27

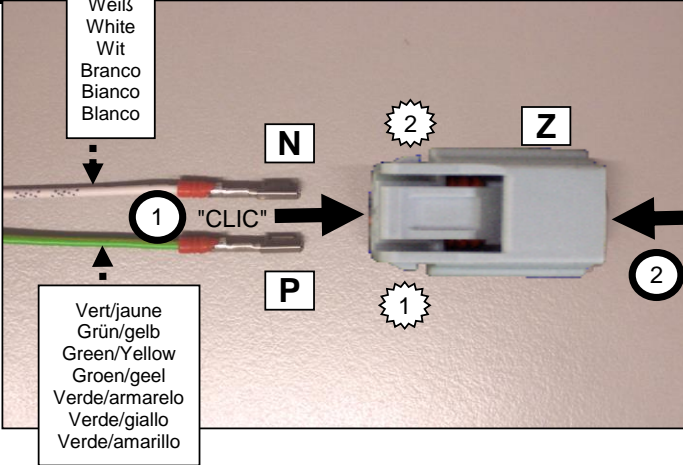

28

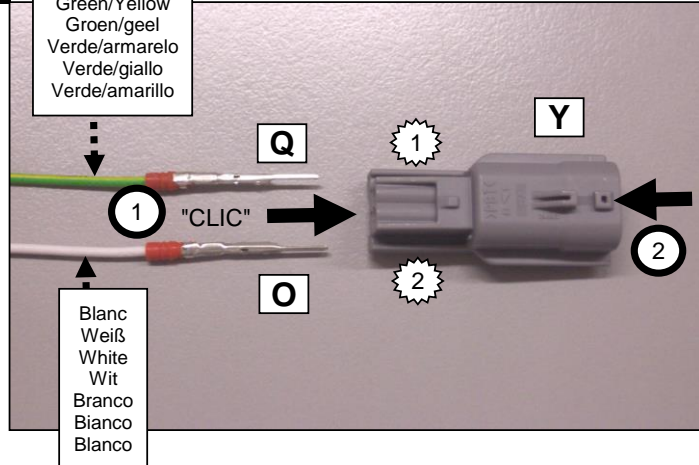

29

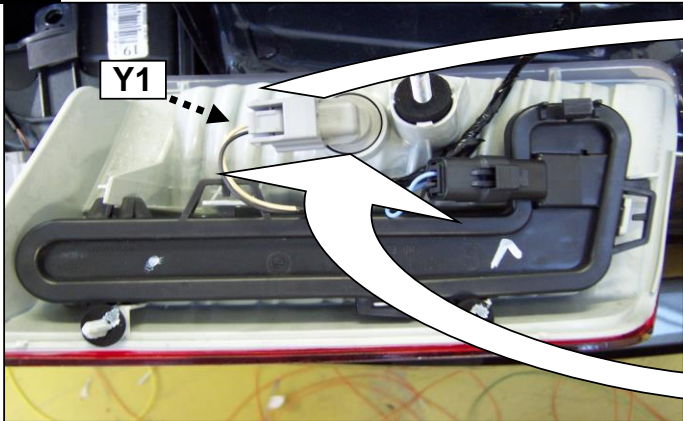

30

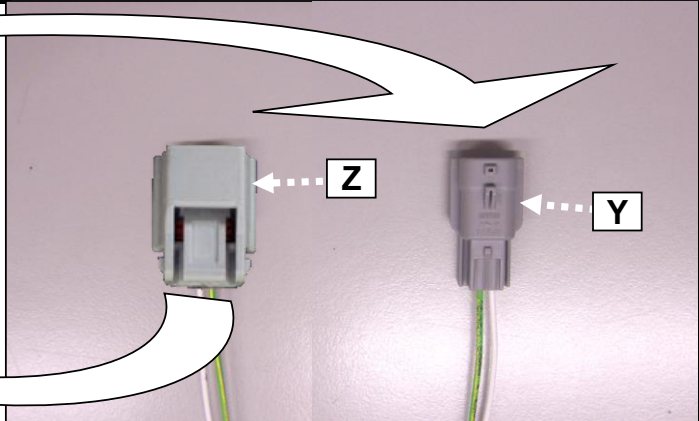

31



32

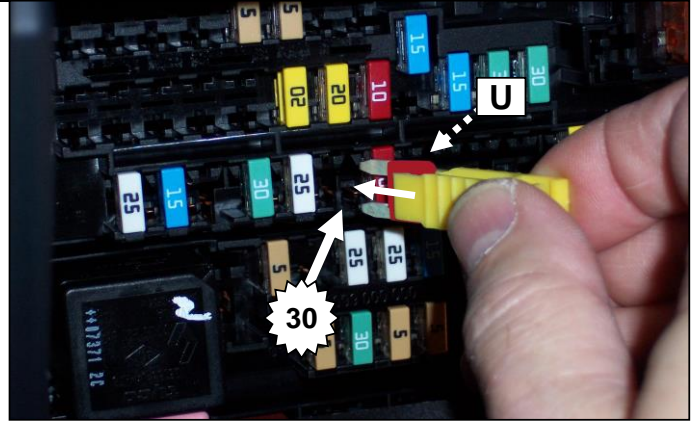

33



34

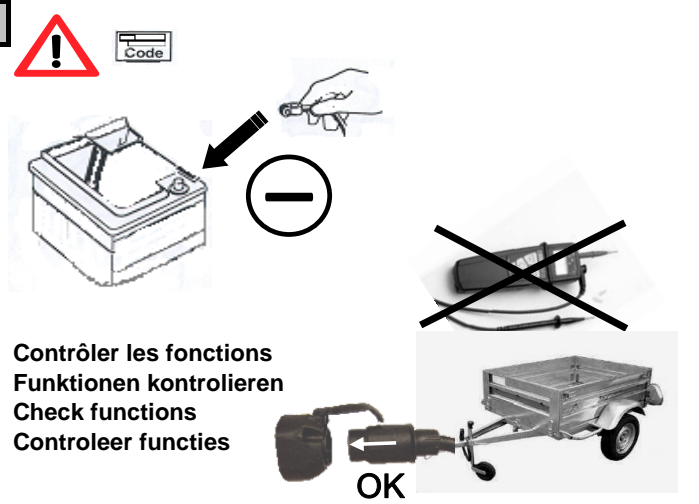

35

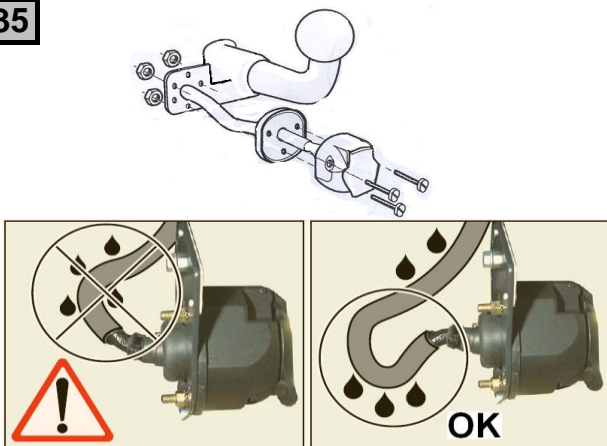

36



Lors du branchement de la remorque ,désactiver le système "RADAR DE RECUL" au tableau de bord
 When you connect the trailer, do remove the function "PARK ASSIST" on the dashboard

